

Adapter-Plates ISAP-K1

Standard dimensions 300 × 200 mm, hole matrix spacing 75 mm

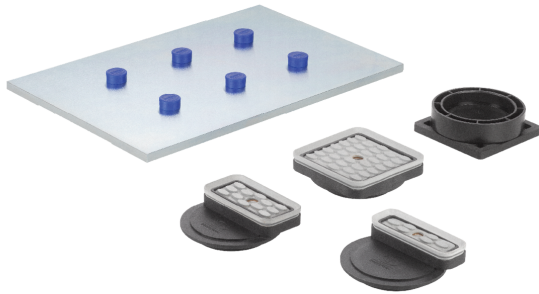

Adapter-Plates ISAP-K1

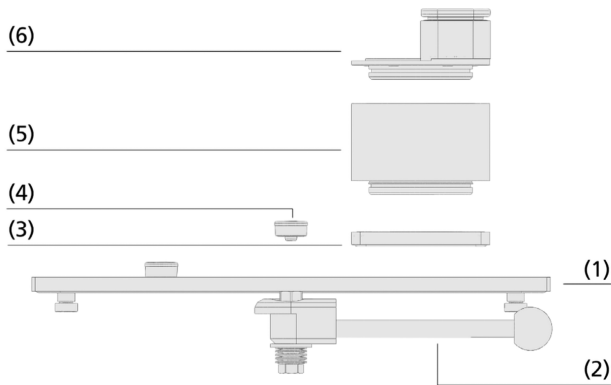

System design Adapter-Plates ISAP-K1

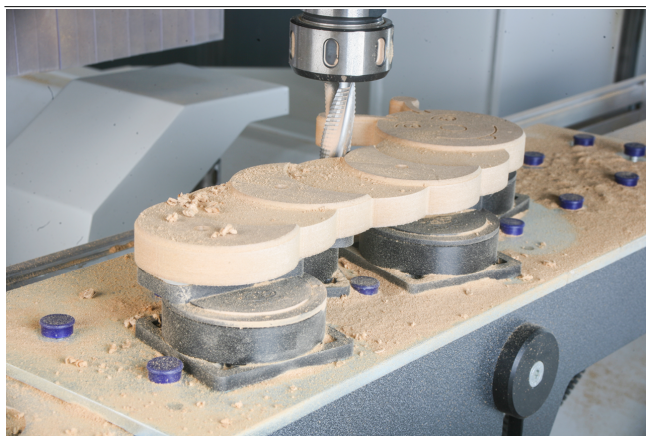

Adapter-Plates ISAP-K1 with Mono-Base and suction cups for clamping curved wooden parts

Suitability for industry specific applications

Application

- Hose-free vacuum clamping system for CNC machining centers with console table (single-circuit system)
- The Adapter-Plates are positioned directly over the vacuum supply on the consoles
- Flexible loading of Adapter-Plates with up to six additional Mono-Bases ISMB and suction cups ISCUP
- Particularly suitable for narrow and curved workpieces with small suction surfaces and delicate molds
- The modular concept with connectible spacer rings enables various working heights
- Non-damaging and precise clamping with maximum holding force

Design

- Adapter-Plate (1) base plate
- Mechanical clamping mechanism (2) for pre-fixing the Adapter-Plate to the console
- Mono-Base (3) for positioning on top of the vacuum openings of the Adapter-Plate and suction cup (6) for fixing the workpiece are available as accessories
- Spacer ring (5) for adjusting the height to the machining height of the machine
- Sealing magnet (4)

Product highlights

- Ideal for narrow and curved workpieces, as plates and vacuum blocks can be flexibly combined
- Freely positionable suction cups and Mono-Bases allow almost any clamping layout
- Mixed operation with standard vacuum blocks possible for even more flexibility and short set-up times
- Accessories and spare parts can be replaced quickly, easily and cost-effectively without tools

Adapter-Plates ISAP-K1

Standard dimensions 300 × 200 mm, hole matrix spacing 75 mm

Designation code Adapter-Plates ISAP-K1

ISAP-K1	–	300x200x8
1		2

1 – Abbreviated designation

Code	Type
ISAP-K1	Innospann adapter plate, 1-circuit console system

2 – Dimensions

Code	LxWxHeight in mm
300x200x8	300x200x8

The adapter plate ISAP-K1 is delivered assembled. The product consists of:

- Base plate made of steel
- Sealing magnets for closing the vacuum openings
- Hand lever for mechanical fixation on the console

Available spare parts: sealing magnet

Available accessories: Mono-Base, spacer ring, suction cup

Ordering data Adapter-Plates ISAP-K1

Type	Part no.
ISAP-K1 300x200x8	10.01.14.00025







Ordering data Spare parts Adapter-Plates ISAP-K1

Type	Part no.
Sealing magnet ISMST 19-7 4ISMST	10.01.14.00847 

Ordering data Accessories Adapter-Plates ISAP-K1

Type	Part no.
Mono-Base ISMB 80x80x8	10.01.15.00188 

Type	Part no.
Spacer ring, Innospann ISZR-V 80x18	10.01.15.00213
Spacer ring, Innospann ISZR-V 80x93	10.01.15.01081

Type	Part no.
Cup ISCUP Cup 1 80x80x16	10.01.15.00209 
Cup ISCUP Cup 2 80x40x16	10.01.15.00210 
Cup ISCUP Cup 3 80x28x16	10.01.15.00211 
Cup ISCUP Cup 1 80x80x30	10.01.15.00003 
Cup ISCUP Cup 2 80x40x30	10.01.15.00004 
Cup ISCUP Cup 3 80x28x30	10.01.15.00005 

Adapter-Plates ISAP-K1

Standard dimensions 300 × 200 mm, hole matrix spacing 75 mm

Design data Adapter-Plates ISAP-K1

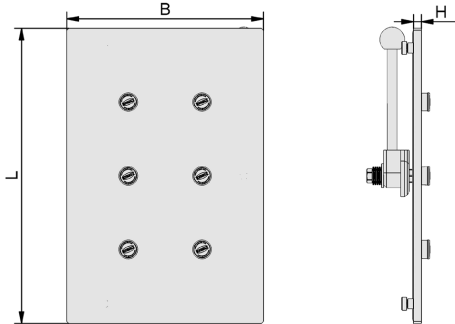

ISAP-K1

Design data Adapter-Plates ISAP-K1

Type	B [mm]	H [mm]	L [mm]
ISAP-K1 300x200x8	200	8	300